

Digital image processing in the monitoring of wide-span timber structures

Robert Pawlowski, Klaudius Henke, Heinrich Kreuzinger, Stefan Winter
Chair of Timber Structures and Building Construction
Technische Universität München, Munich, Germany

Peter Schregle
Impuls computergestützte Bildanalyse GmbH, Gilching, Germany

Gymnasium in Murnau, Bavaria, Germany



Gymnasium in Murnau – Snow loads

Snow load to DIN 1055-5:1975-06 (valid until 2006-12-31):

$$s_0 = 1.50 \text{ kN/m}^2$$

Snow load to DIN 1055-5:2005-07 (valid since 2007-01-01):

$$s_k = 3.80 \text{ kN/m}^2$$

Längsschnitt durch die Hauptträger:

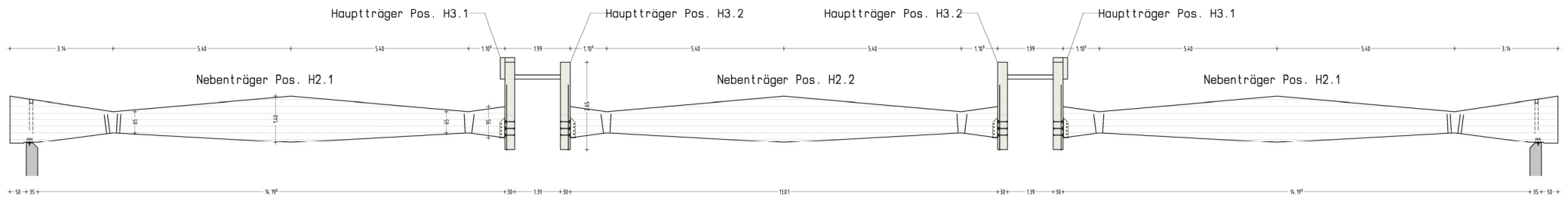

Querschnitt entlang des Hauptträgers:

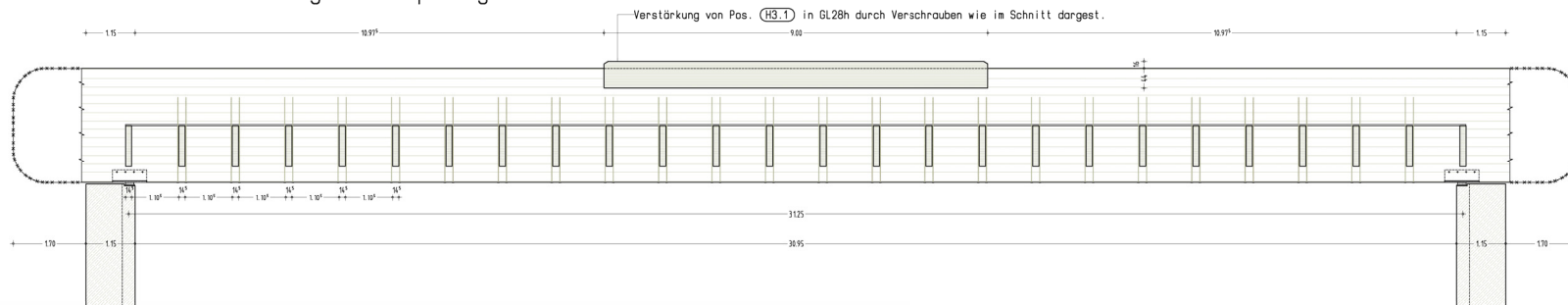

Gymnasium in Murnau – Load-bearing capacity

The degree of utilisation according to DIN 1052:2004-08 and DIN 1055-5:2005-07

- 1** Main beam support: $\eta=1.60$
- 2** Main beams (Pos. H3.1): $\eta=1.10$

Längsschnitt durch die Hauptträger:

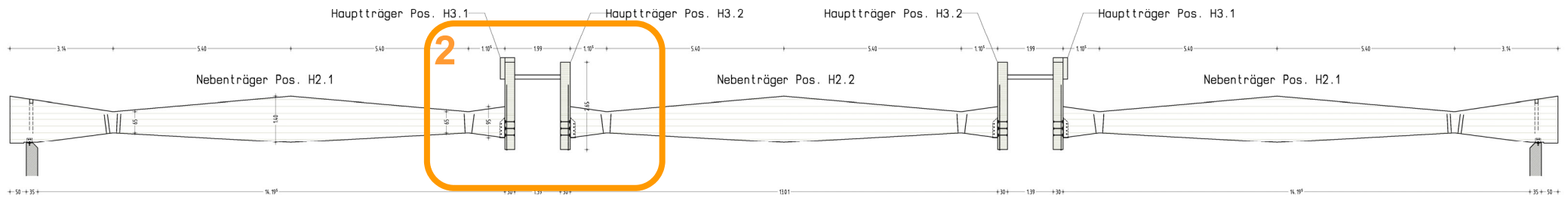

Querschnitt entlang des Hauptträgers:

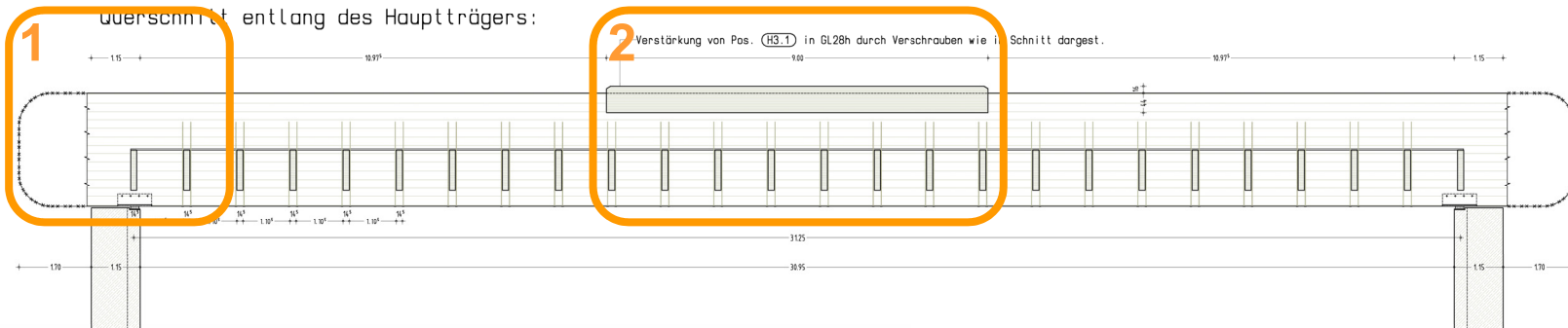

Gymnasium in Murnau – Main beam support

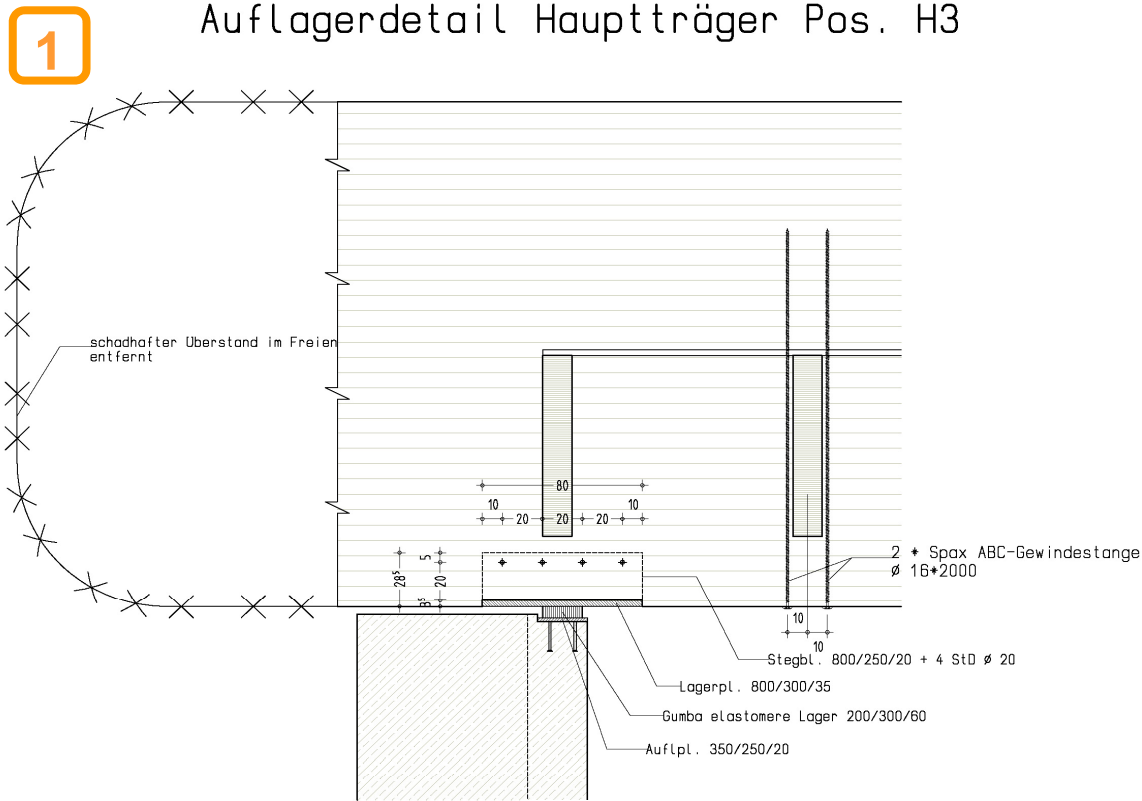

$$\frac{\sigma_{c,90,d}}{k_{c,90} \cdot f_{c,90,d}} \leq 1$$

mit

$$\sigma_{c,90,d} = \frac{F_{c,90,d}}{A_{ef}}$$

Dabei ist

A_{ef} die wirksame Querschnittsfläche,

Tabelle 10/1. Beiwert $k_{c,90}$

Baustoff	$l_1 < 2 \cdot h$	$l_1 \geq 2 \cdot h$	
		Schwellen- druck	Auflagerdruck $l \leq 400 \text{ mm}$
BS-Holz aus NH	1,0	1,5	1,75 ⁾
VH aus NH	1,0	1,25	1,5
VH aus LH		1,0	

⁾ Für $l > 400 \text{ mm}$ darf mit $l = 400 \text{ mm}$ und $k_{c,90} = 1,75$ gerechnet werden.



Gymnasium in Murnau – Main beam support

1

Auflagerdetail Hauptträger Pos. H3

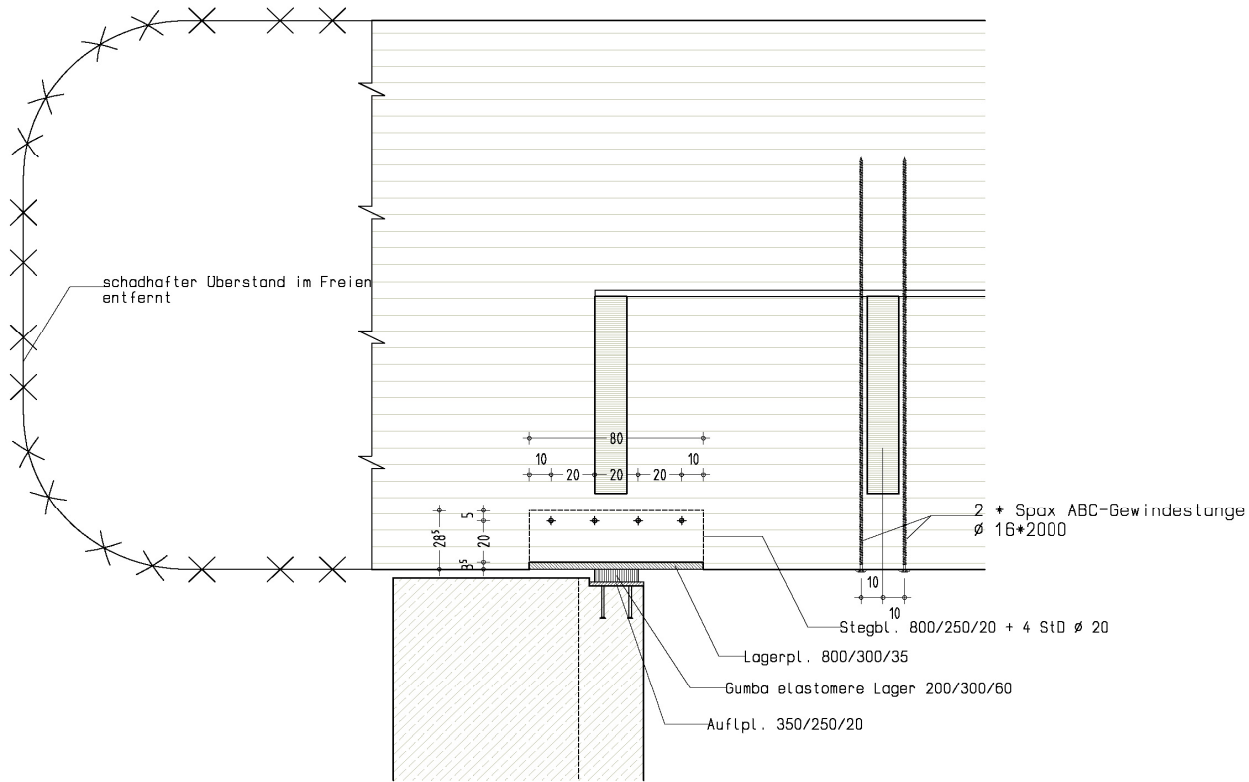

Gymnasium in Murnau – Main beams

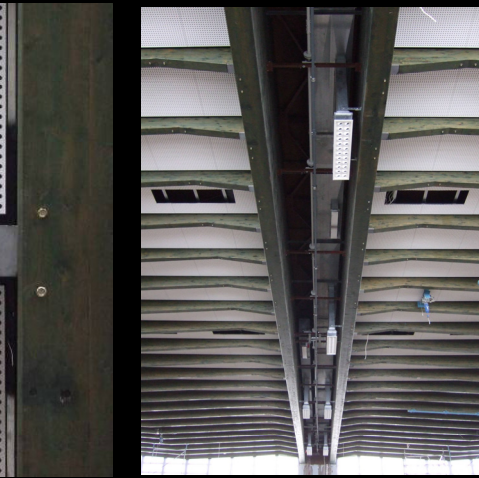

2

Schnitt Hauptträger Pos. H3:

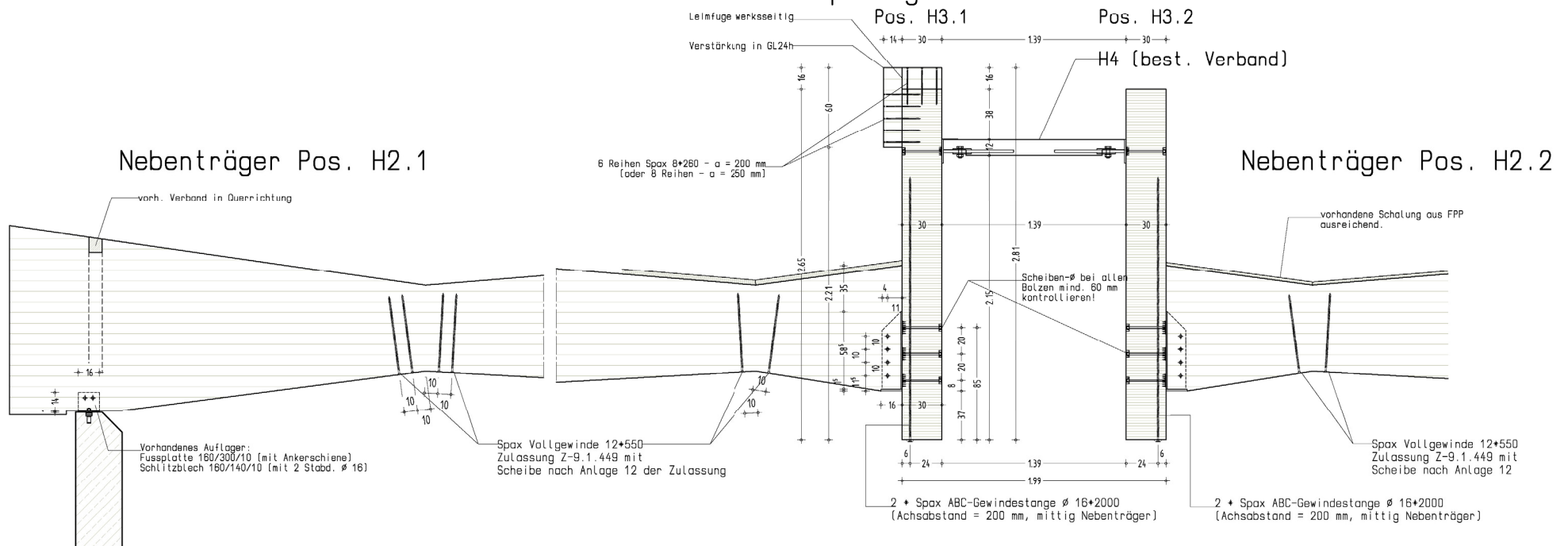

Gymnasium in Murnau – Monitoring systematics

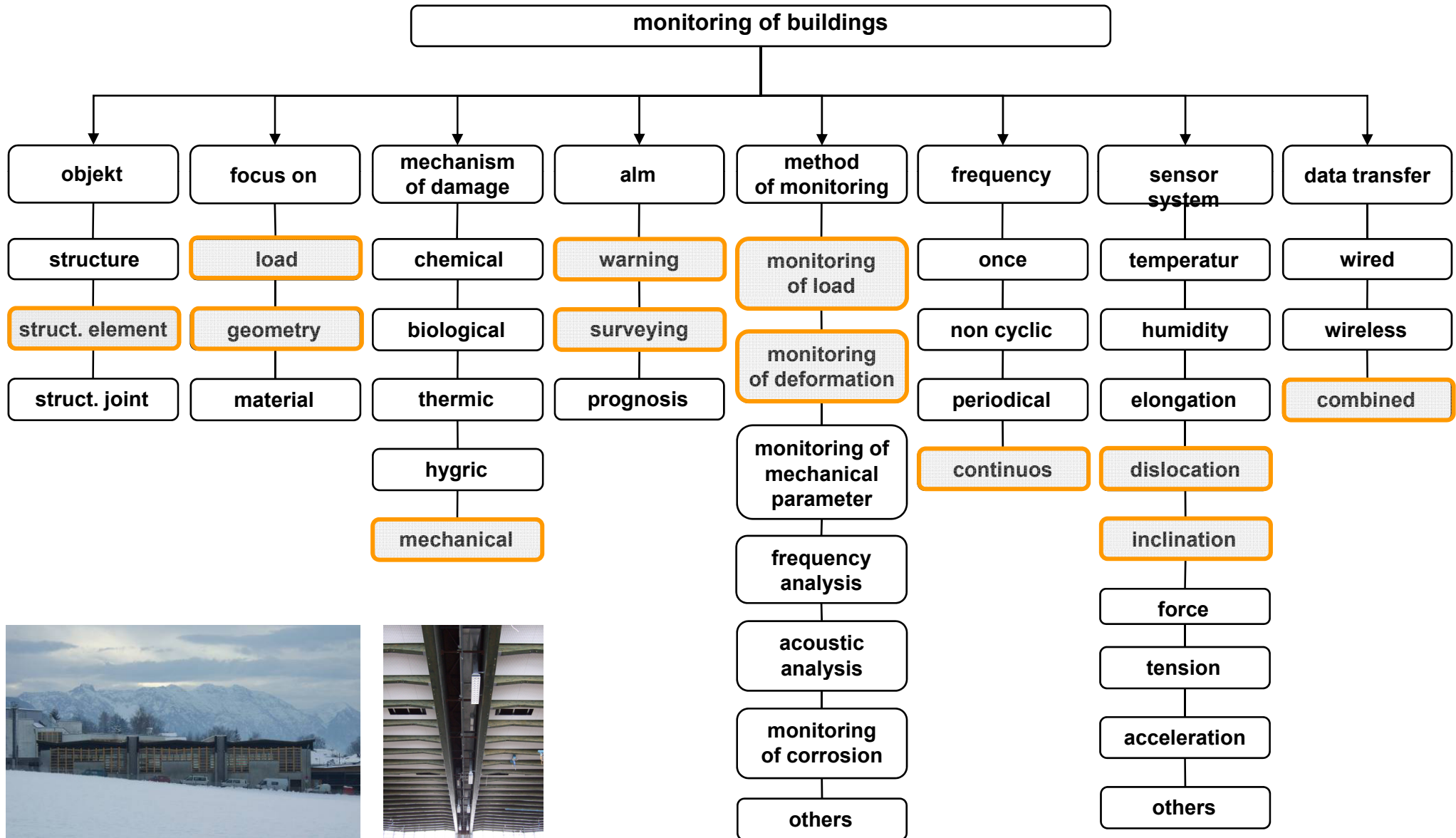

Gymnasium in Murnau – Digital image processing

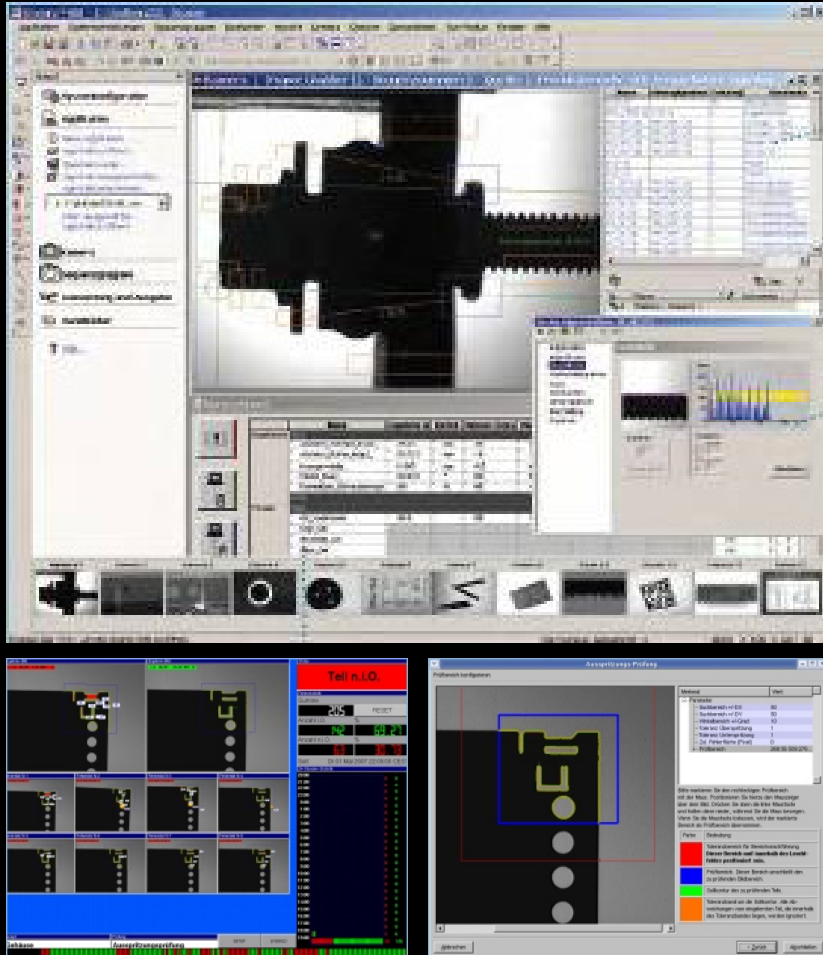

Gymnasium in Murnau – First preliminary test (TUM)

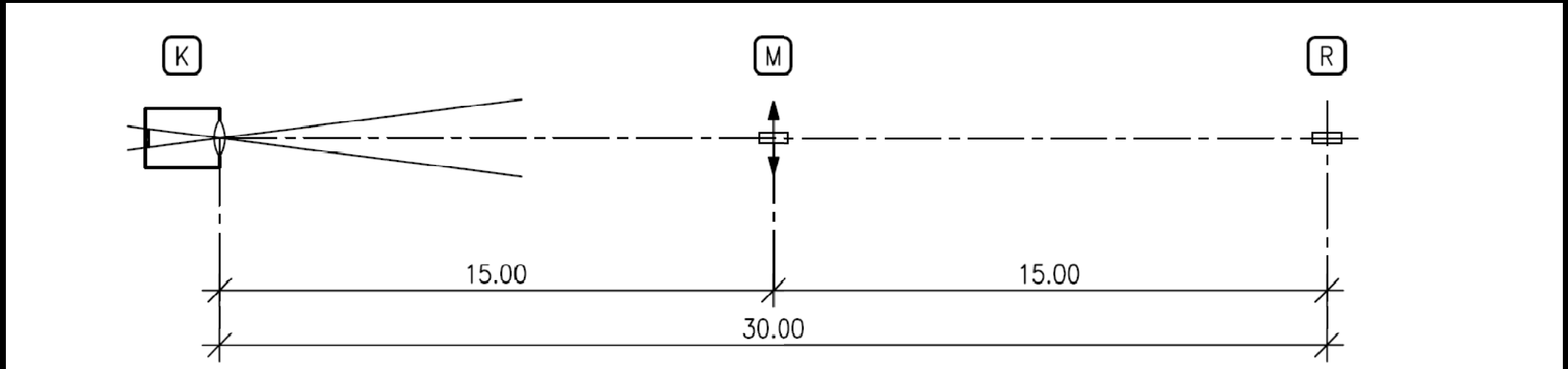

Gymnasium in Murnau – First preliminary test (TUM)

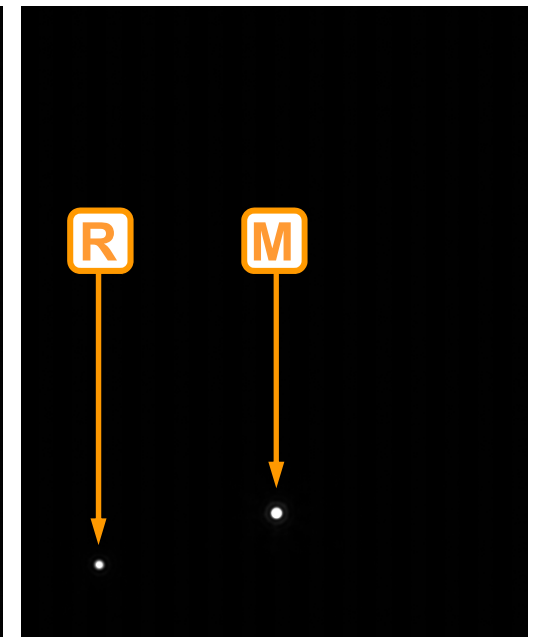
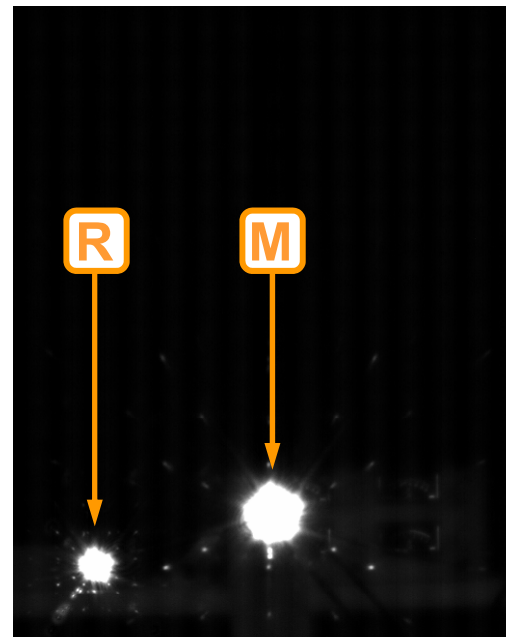
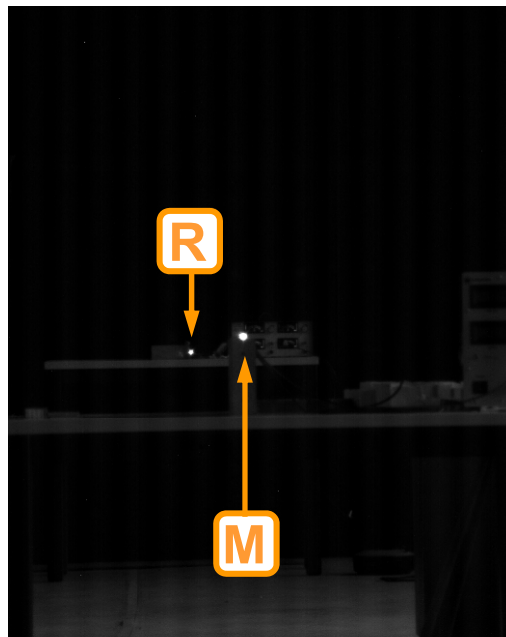
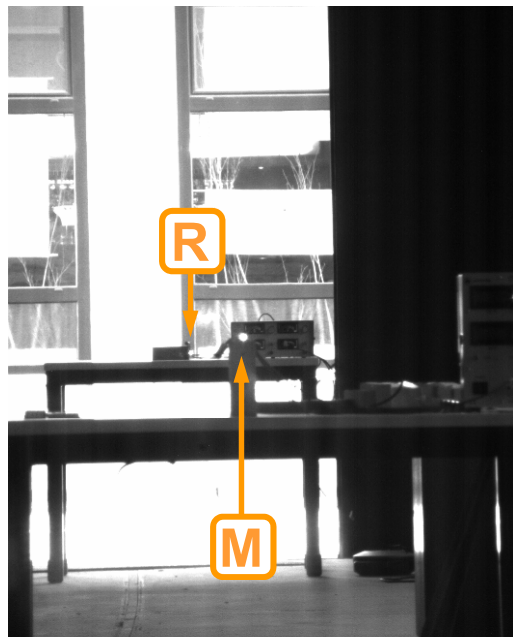
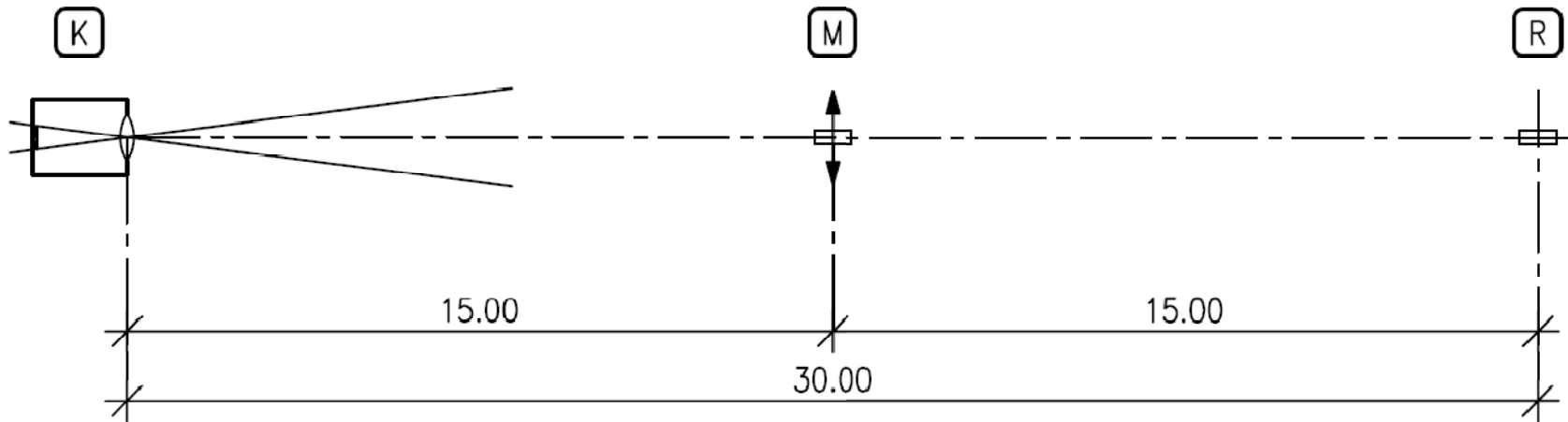

Gymnasium in Murnau – First preliminary test (TUM)

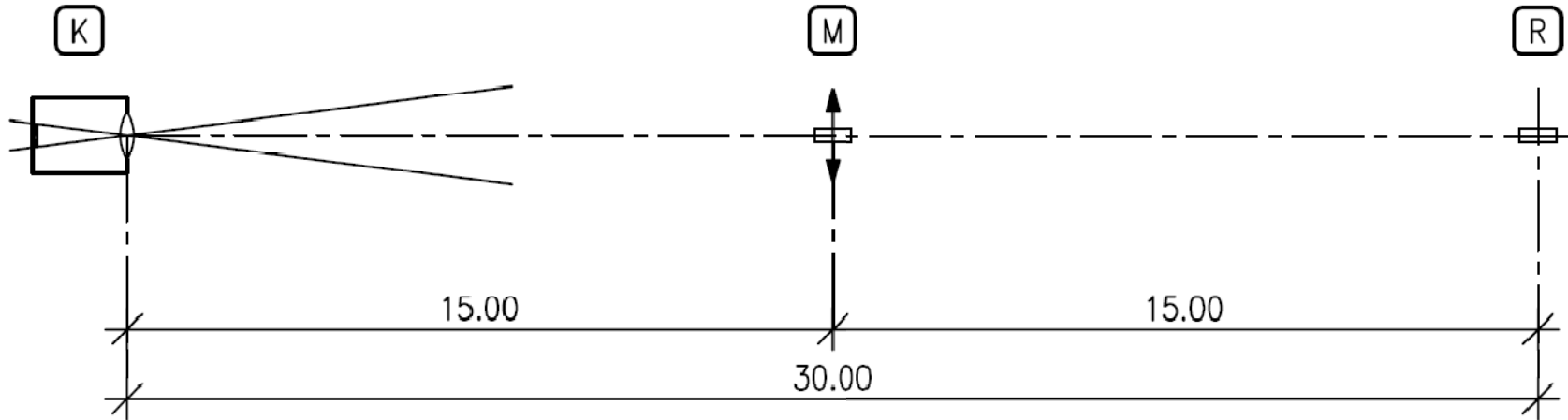

0°

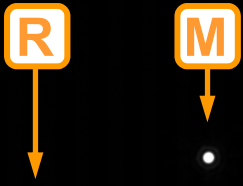

5°

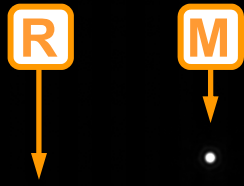

10°

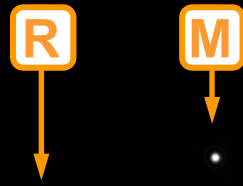

15°

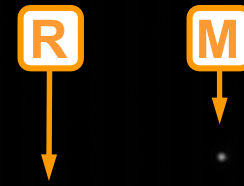

Gymnasium in Murnau – Second preliminary test (Murnau)

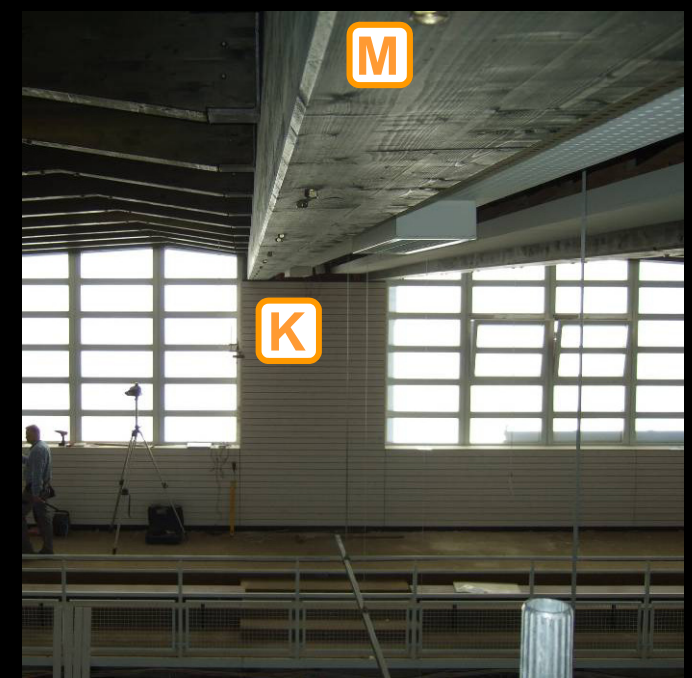
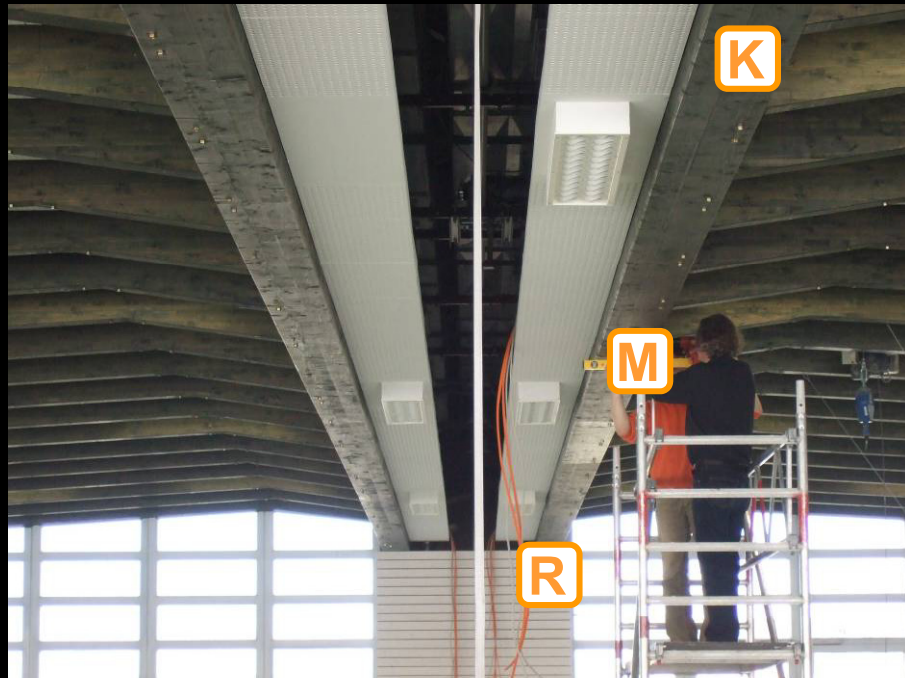
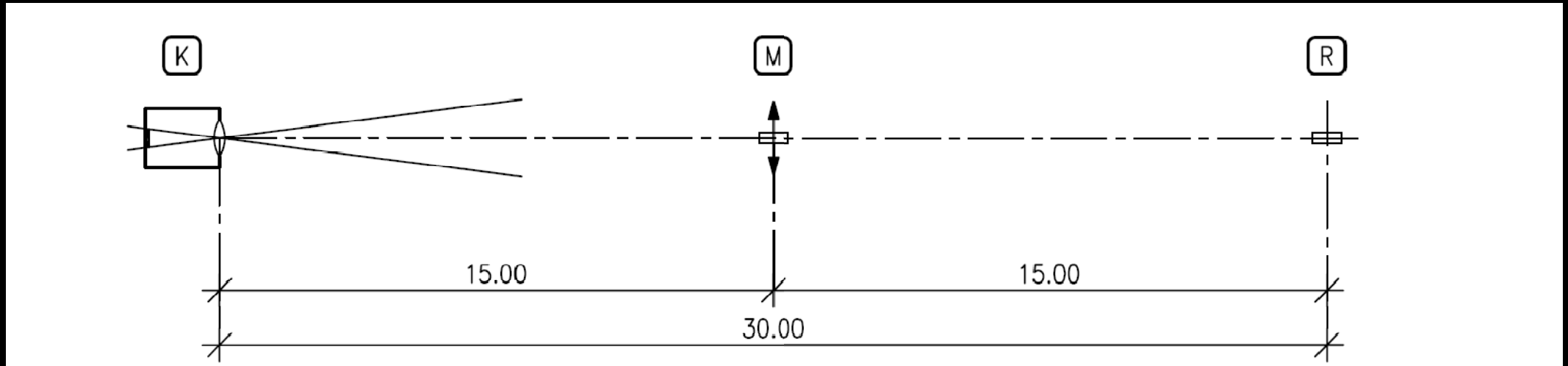

Gymnasium in Murnau – Second preliminary test (Murnau)

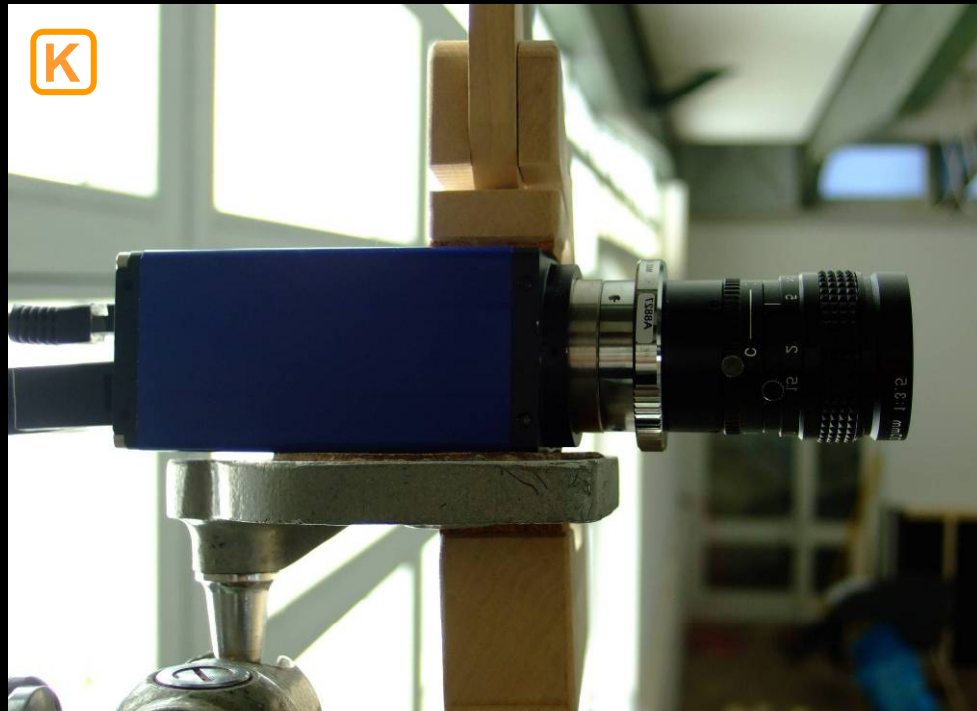
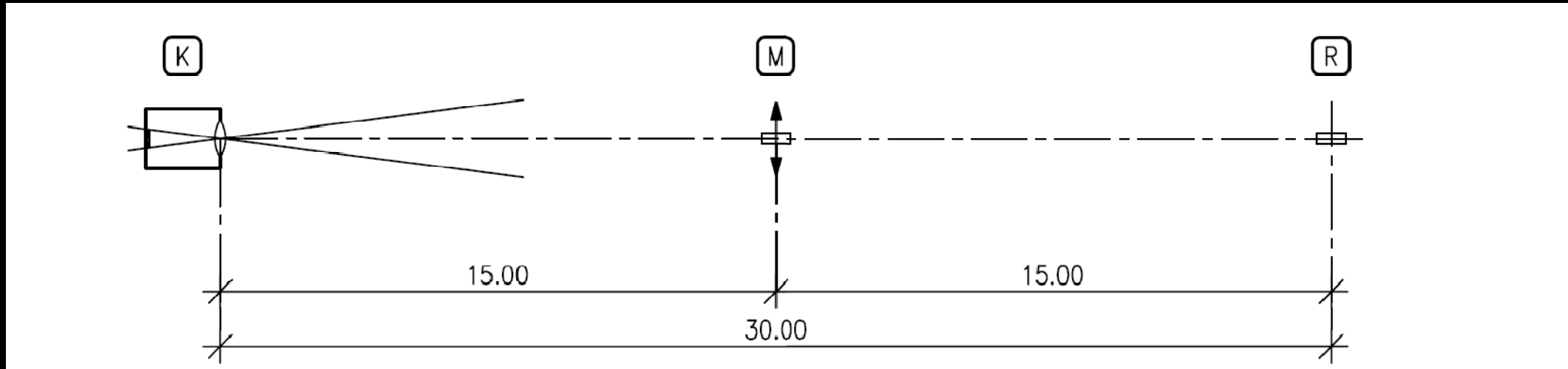

Gymnasium in Murnau – Second preliminary test (Murnau)

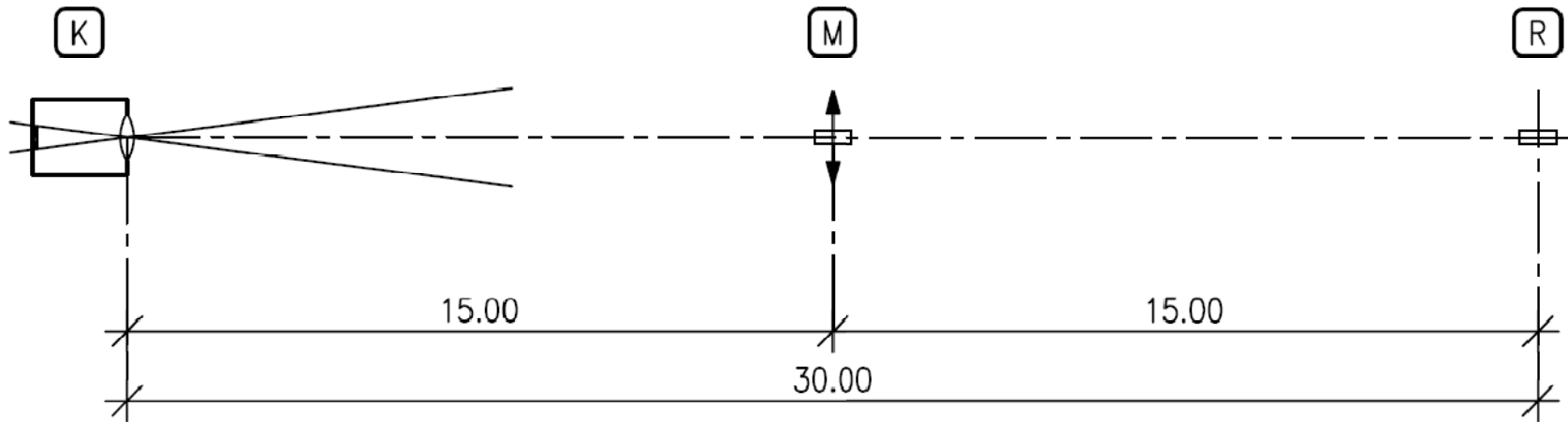

Vertical deflection of measuring point M

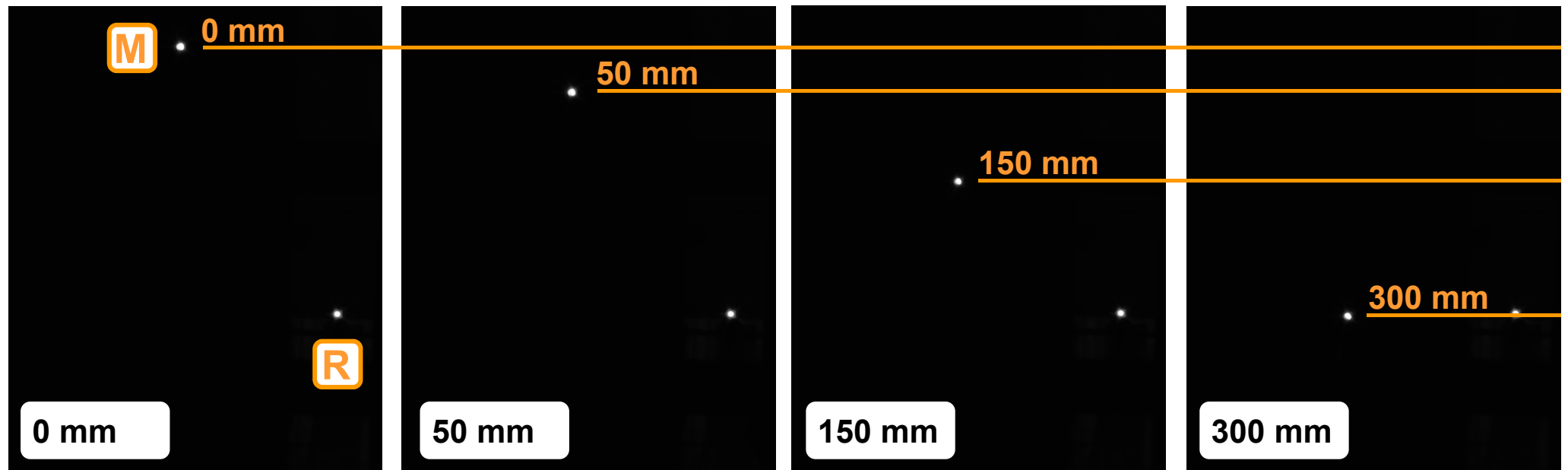

Gymnasium in Murnau – Second preliminary test (Murnau)

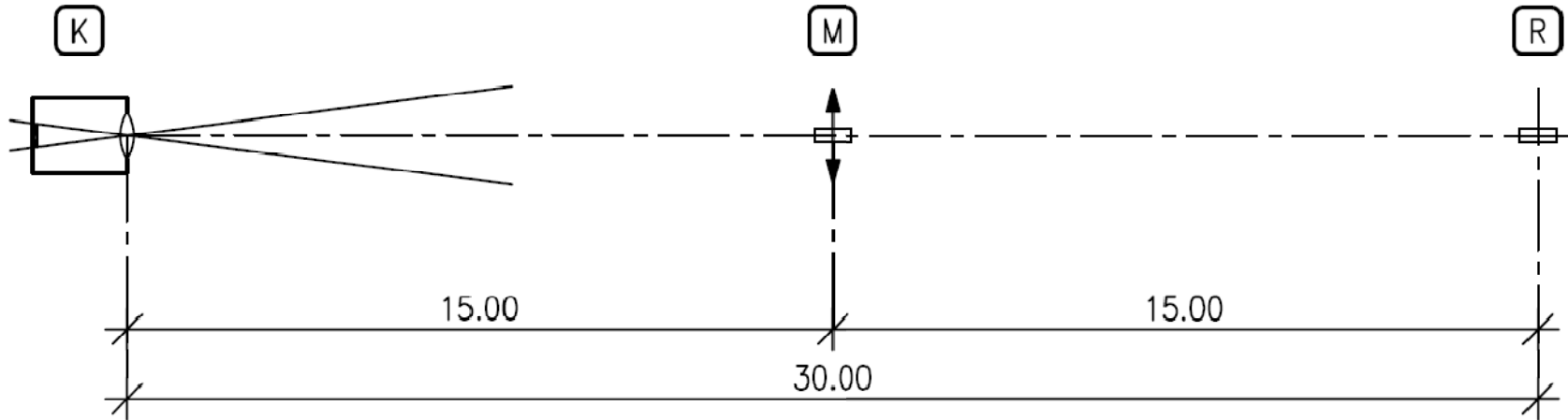

Vertical deflection of measuring point M

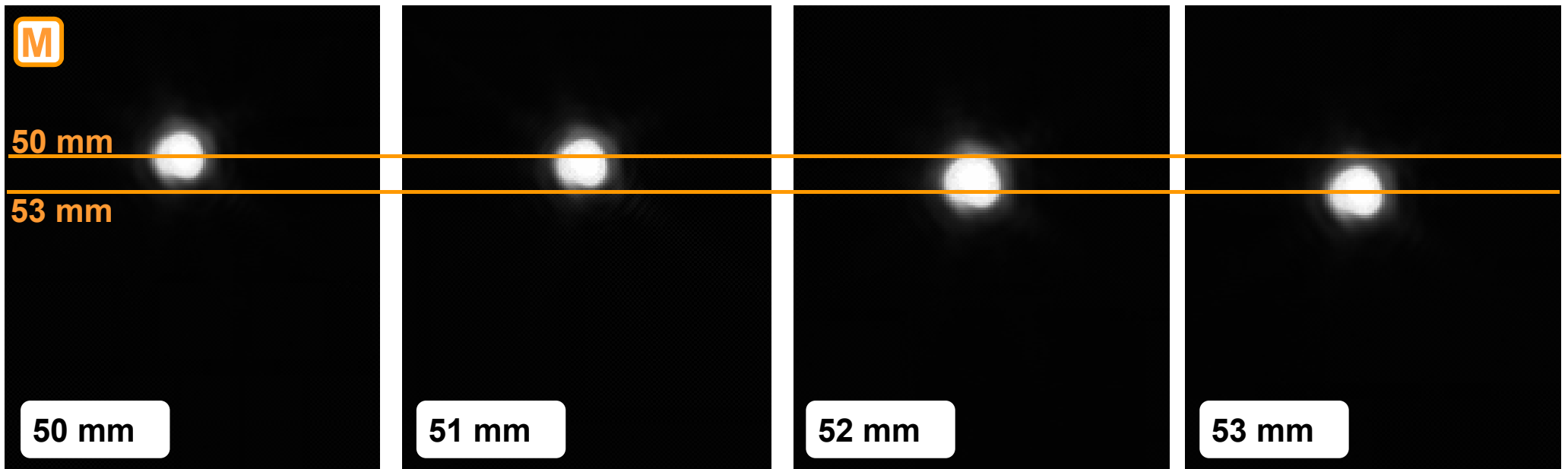

Gymnasium in Murnau – Second preliminary test (Murnau)

Vertical deflection of measuring point M

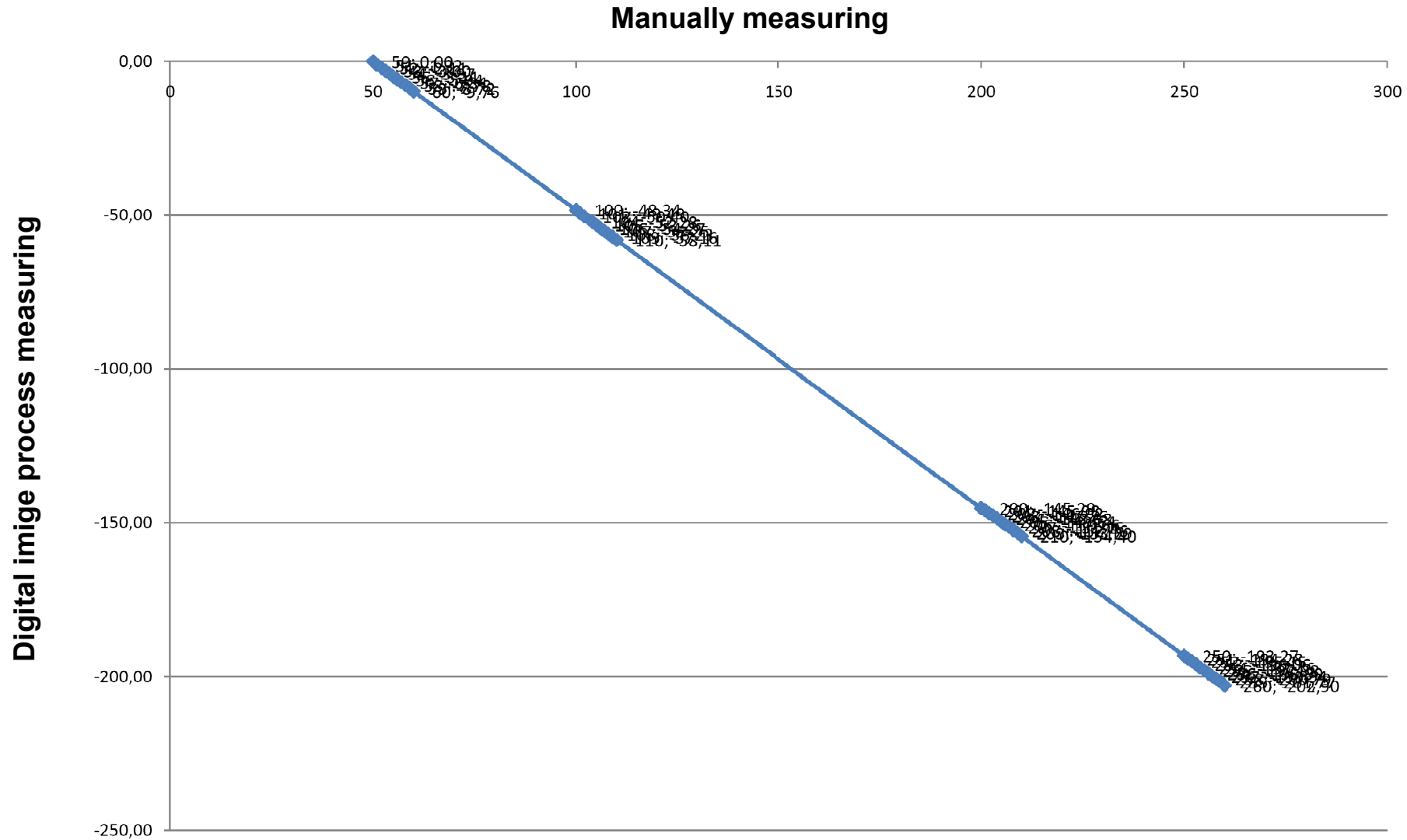

Gymnasium in Murnau – Monitoring system

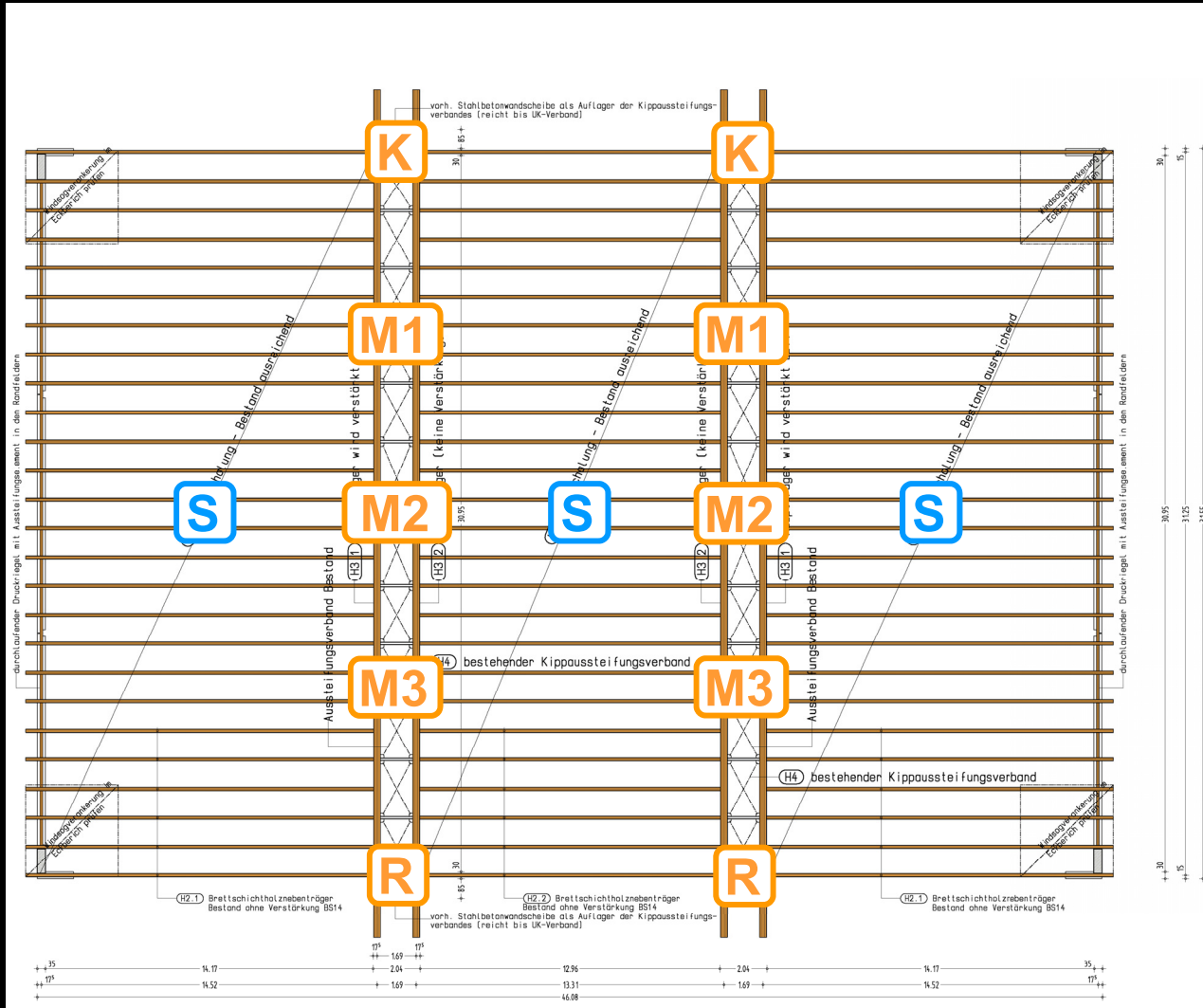

K Camera

M Measuring point

R Reference point

S Measuring of snow load

Gymnasium in Murnau – Monitoring system

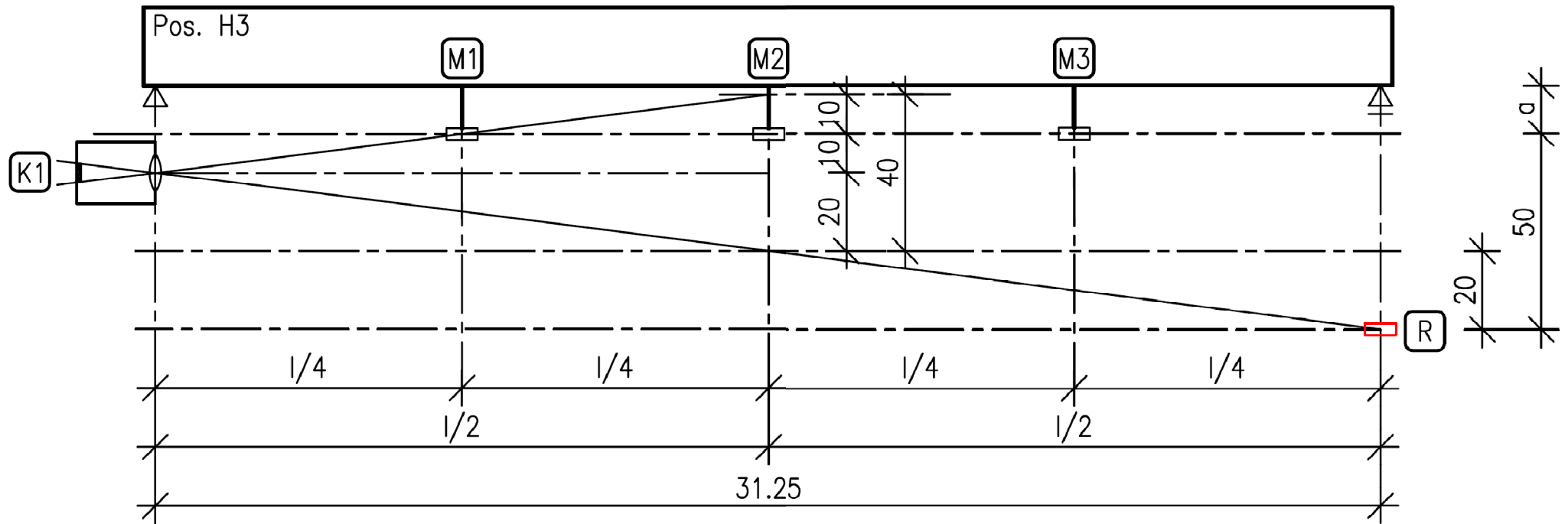

Gymnasium in Murnau – Monitoring system – View of measuring points

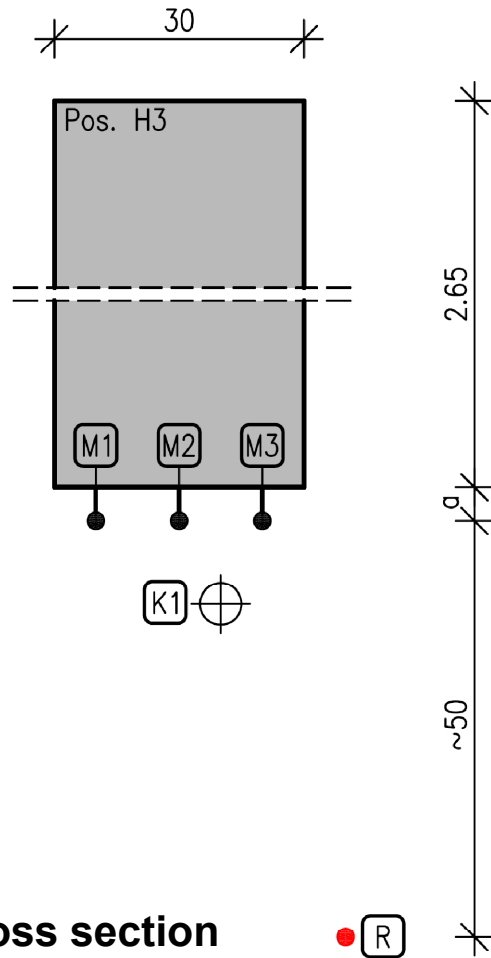

Cross section

View of measuring points for

load case: min $s = 0$
(without snow load)

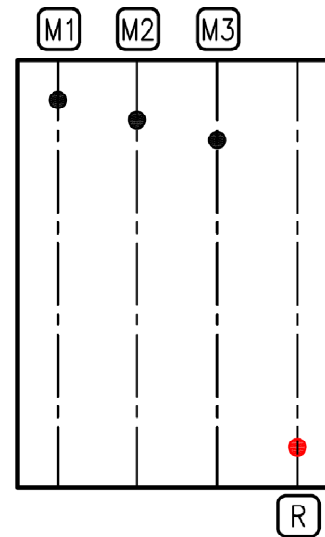

load case: max s
(for maximal snow load)

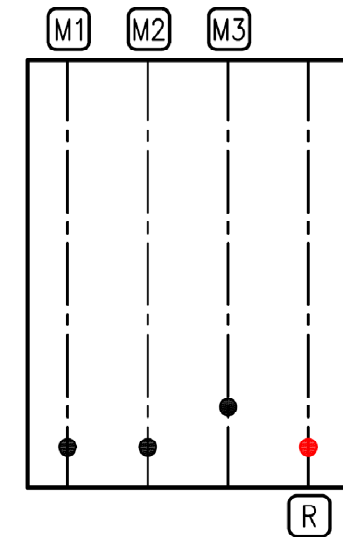

Gymnasium in Murnau – Monitoring system

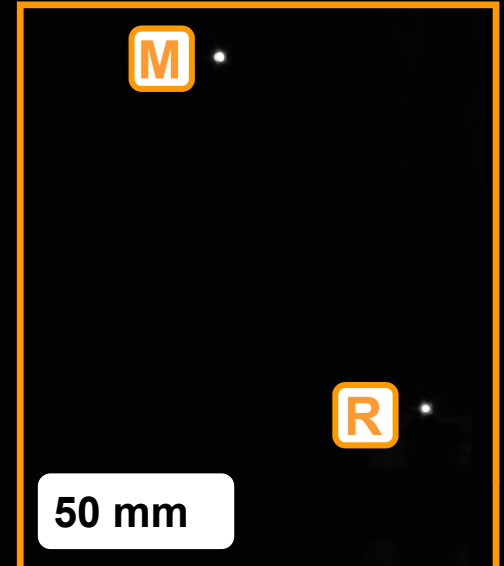
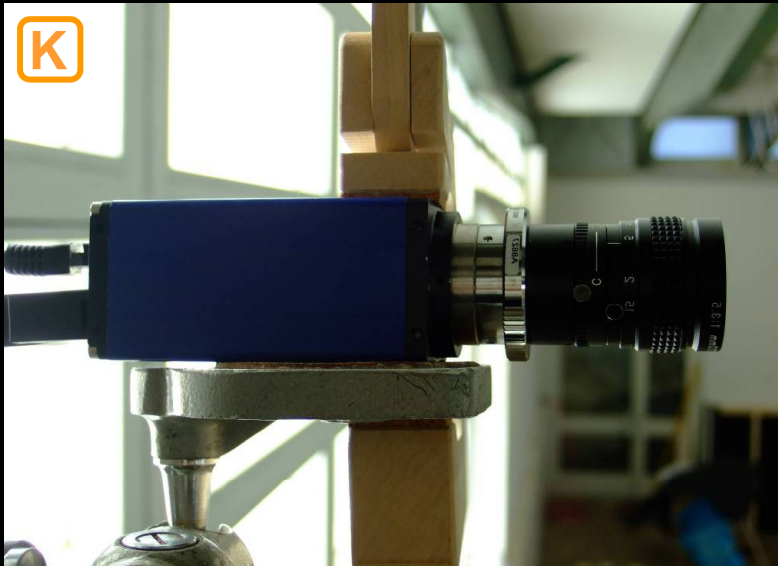

Digital image processing in the monitoring of wide-span timber structures

Robert Pawlowski, Klaudius Henke, Heinrich Kreuzinger, Stefan Winter
Chair of Timber Structures and Building Construction
Technische Universität München, Munich, Germany

Peter Schregle
Impuls computergestützte Bildanalyse GmbH, Gilching, Germany

